



MILLER REAL ESTATE TEAM  
2 - 6820 Parklands Place





Welcome to this two bedroom, two bathroom home located in desirable Upper Lantzville in a 55+ park. A fantastic location just minutes from all North Nanaimo amenities. Built in 2014, this unit offers an open floor plan and vaulted ceilings. The kitchen boasts four stainless appliances and abundant cabinetry. The primary bedroom features

a walk-in closet and three piece ensuite. A second bedroom and four piece main bathroom are located at the opposite side of the home. A laundry room with exterior access completes the unit. A lovely outdoor area includes a covered patio and privacy fence.

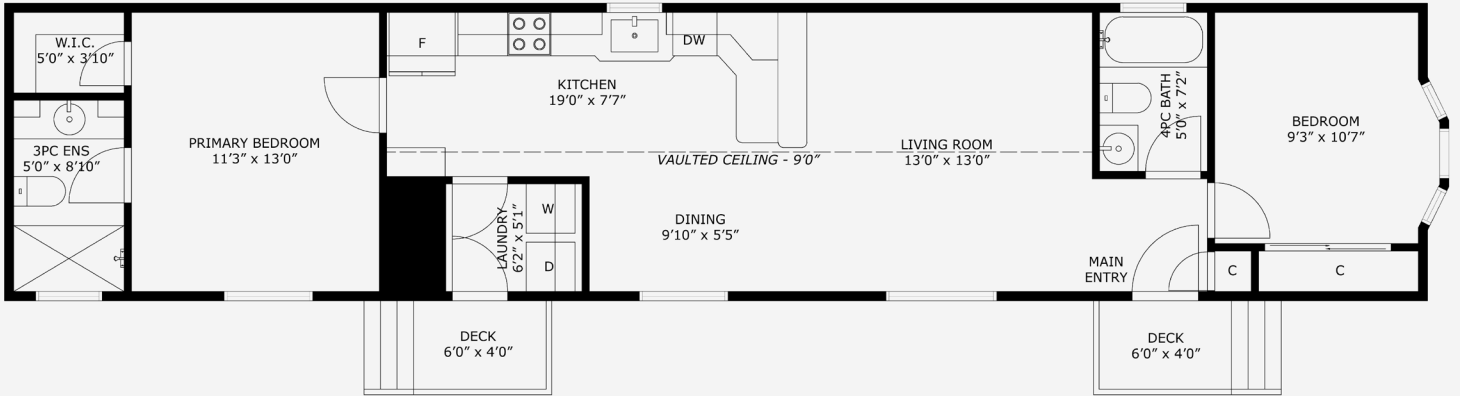

## Specifications & Floor Plan



City: Lantzville  
 Zoning: MHP  
 Home Size: 924 sqft  
 Lot Size: 7,147 sqft  
 Year Built: 2014  
 Bedrooms: 2  
 Bathrooms: 2  
 Heat: Natural Gas - Electric

# Lantzville

All data & measurements are approximate & should be verified if important.



Thank you for viewing 2 - 6820 Parklands Place  
Additional Information Available at [MillerRealEstate.com](http://MillerRealEstate.com)



Additional Professional  
Photographs

Available to  
View on the  
Miller Real  
Estate Team  
Website

3D Immersive  
Tour & Interactive Floor Plan

Custom Video with Exterior  
& Interior Highlights

**Andrew Miller**

PersonalRealEstateCorporation

**Jim Miller**

PersonalRealEstateCorporation



MILLER REAL ESTATE TEAM

**RE/MAX**  
OF NANAIMO

Each Office Independently Owned and Operated

250.751.1223

• [MillerRealEstate.com](http://MillerRealEstate.com)

• 1-5140 Metral Dr