



MILLER REAL ESTATE TEAM  
1 - 3744 Rock City Road







Welcome to this half duplex located in desirable Departure Bay just steps from access to the hiking trails of Linley Valley. Inside is a great floor plan with three good sized bedrooms. The kitchen features abundant white cabinetry and three appliances. The living room has a wall of windows and is open to the adjoining dining room. An updated four piece bathroom, laundry

room and storage room complete the home. The outdoor area is incredibly private and a storage shed is shared with the neighbouring unit. For more information on this property see the 3D tour, video and floor plan. All data and measurements are approximate and must be verified if fundamental.



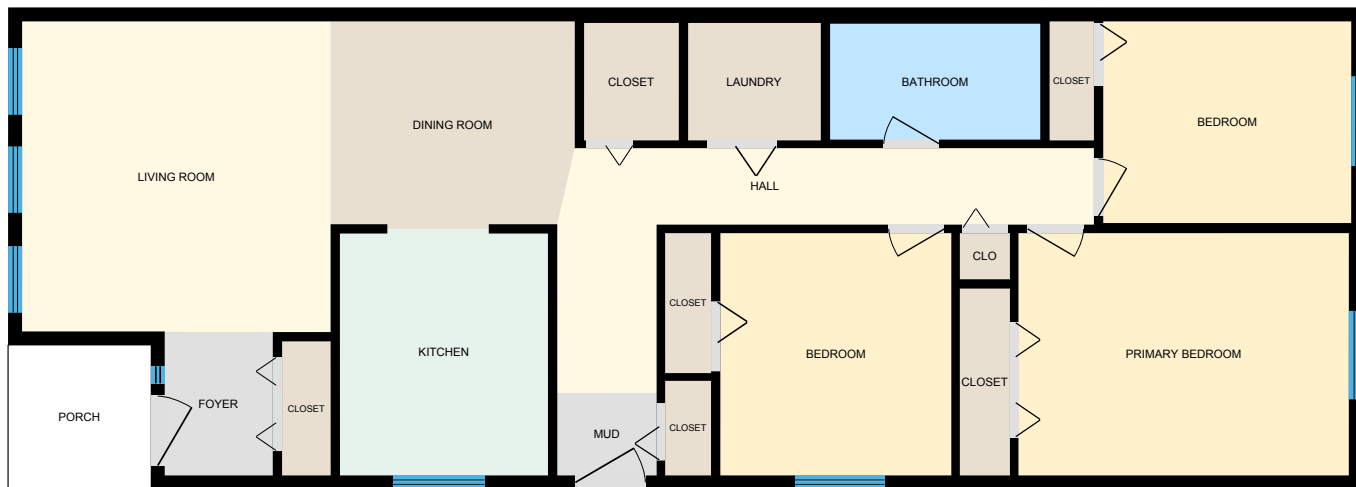

## Floor Plan and Specifications



City: Nanaimo

Zoning: R4

Home Size: 1,076 sq ft

Taxes: \$2,475 (2020)

Layout: Rancher Half Duplex

Construction: Frame

Exterior Finish: Wood

Roof: Fibreglass Shingle

Bedrooms: 3

Bathrooms: 1

Heat: Electric Baseboard

Year Built: 1991

Schools: Rock City Elementary & Wellington Secondary

# Departure Bay

All data & measurements are approximate  
& should be verified if important.





Thank you for viewing 1 - 3744 Rock City Road  
Additional Information Available at [MillerRealEstate.com](http://MillerRealEstate.com)



MILLER REAL ESTATE TEAM

**Joan Miller**  
Personal Real Estate Corporation

**RE/MAX**  
**OF NANAIMO**  
Each Office Independently Owned and Operated

250.751.1223 • [MillerRealEstate.com](http://MillerRealEstate.com) • 1-5140 Metral Dr